

RS ITEM NO 207-810

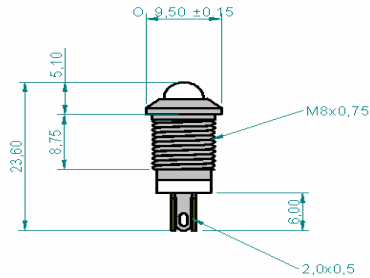

GENERAL TOLERANCE +/-0,25

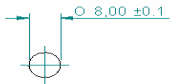

PANEL CUTOUT

LED/Multiled	<i>LED</i>	Optimum voltage (V)	<i>2Vdc</i>	Intensity	<i>Red 80mcd@20mA Green 50mcd@20mA</i>
Mounting Size	<i>8mm</i>	Rectifier	-	Reverse Voltage	<i>5V(max)</i>
Mounting Finish	<i>Prominent</i>	AC current	-		
Protection	<i>IP60</i>	DC current	<i>24mA(max)</i>		
Mount Holder	<i>Black Bezel</i>	Voltage Tolerance(%)	<i>10%</i>		
Chip Qty	<i>1</i>	Optimum temperature (°C)	<i>-25°C...+60°C</i>		
Indicator colour	<i>Red/Yellow/Green</i>	Storage temperature (°C)	<i>-25°C...+60°C</i>		
Wavelength (nm)	<i>625/588/568</i>	Contact Tab x 3	<i>2.80x0.8mm</i>		



Dimension in mm (typical) not to scale

We reserve the right to make changes without further notice to his product to improve reliability, function or design

