

TX200PV robot series Photovoltaics



New

RS
Scara / 4 axis

TX
Low payload / 6 axis

TX
Medium payload / 6 axis

TX
Heavy payload / 6 axis

MODEL		TX200PV	TX200PVL
Characteristics			
Maximum load ⁽¹⁾		130 kg	80 kg
Nominal load		100 kg	60 kg
Reach (between axis 1 and 6)		2194 mm	2594 mm
Number of degrees of freedom		6	6
Repeatability - ISO 9283		± 0,06 mm	± 0,1 mm
Motion range	Axis 1 (A)	± 180°	± 180°
	Axis 2 (B)	± 120°	± 120°
	Axis 3 (C)	+145°/-140°	+145°/-140°
	Axis 4 (D)	± 270°	± 270°
	Axis 5 (E)	±120°	±120°
	Axis 6 (F)	± 270° ⁽²⁾	± 270° ⁽²⁾
Work envelope	Maximum reach between axis 1 and 5 (R. M)	2000 mm	2400 mm
	Maximum reach between axis 2 and 5 (R. M)	1750 mm	2150 mm
	Minimum reach between axis 1 and 5 (R. m1)	365 mm	528 mm
	Minimum reach between axis 2 and 5 (R. m2)	545 mm	690 mm
	Minimum reach between axis 3 and 5 (R. b)	800 mm	1200 mm
Maximum speed	Axis 1	150°/s	150°/s
	Axis 2	150°/s	150°/s
	Axis 3	150°/s	150°/s
	Axis 4	260°/s	260°/s
	Axis 5	260°/s	260°/s
	Axis 6	400°/s	400°/s
Maximum speed at load gravity center		12.5 m/s	14.5 m/s
Maximum inertias	Axis 5	30 kg.m ²	20 kg.m ²
	Axis 6	20 kg.m ²	15 kg.m ²
Weight		1000 kg	1020 kg
Brakes		All axis	
Forearm connections	Pneumatic	2 solenoid valves in option 5/2-way monostable (compressed air) 3 direct line between the base and the forearm	
	Electrical	1 female 19-contact socket (7 twisted pairs including 2 shielded, 3 power contacts)	
Cleanroom standard - ISO 14644-1		5	
Protection class (*wrist) according to standard NF EN 60529		IP65 (*67)	
Stäubli CS8 series controller		CS8C HP	
Installation environment			
Working temperature according to standard directive NF EN 60 204-1		+ 5°C to + 40°C	
Humidity according to standard directive NF EN 60 204-1		30% à 95% max. non-condensing	
Attachment methods		Floor/Shelf/Ceiling ⁽⁶⁾	
Vertical cable outlet version ⁽³⁾		•	•
Pressurized version ⁽⁴⁾		•	•
Version HE (Humid Environment) ⁽⁵⁾		• ⁽⁶⁾	• ⁽⁶⁾
Market specific versions			
CR Cleanroom - class 4 cleanliness - ISO 14644-1		• ⁽⁶⁾	• ⁽⁶⁾

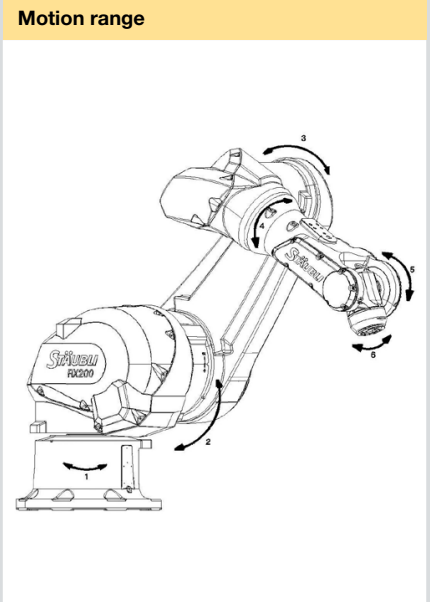

CS8C HP controller



(1) Under special conditions, consult us.

(2) Software configurable up to ±18000°.

(3) Vertical outlet version: designed to offer additional connection protection at robot base or for use in clean and/or humid environment. Factory installation only.

(4) Pressurization kit : necessary for use in an environment with high dust levels or with substantial liquid splashing. This kit generates positive pressure in the arm. Factory installation only and required with Pressurization kit.

(5) Version HE (Humid Environment) : designed for use in humid and oxidizing environments. The arm components are painted individually, providing additional arm protection against oxidation and corrosion. Factory installation only and required with Pressurization kit.

(6) Contact our sales team.



Product benefits

The TX200PV robot series feature unique benefits to fit photovoltaic applications providing the best possible process quality and increased productivity. These robots are specifically designed for use in clean environments and have a Cleanroom standard of 5 based on ISO14644-1 certification with a rating of 4 for the CR Cleanroom version. If servicing is required on the robot arm, the arm integrity is maintained, the arm keeping its original Cleanroom class without particular reconditioning process.



WRIST

IP67 rating, high robustness, limited build-up on wrist.



VERTICAL CABLE OUTLET VERSION

Better cable protections, use in clean and/or humid environment.

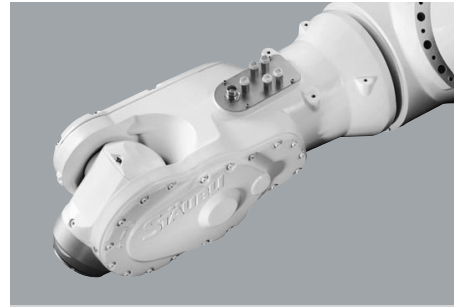

FOREARM CONNECTIONS

Electrical and pneumatic connections close to the tool, user lines already installed

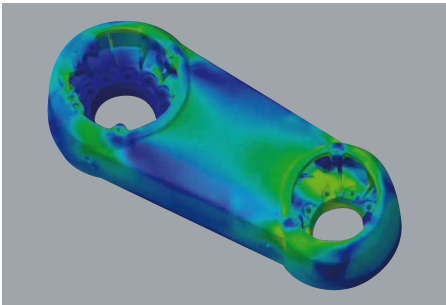

RIGID STRUCTURE

Better dynamic performance.

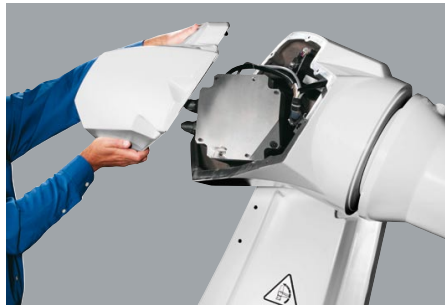

ENCLOSED STRUCTURE

Easy to clean and use in clean or hostile environments.



ENVIRONMENT

The robot is available in different versions : Cleanroom, Humid Environment (HE), Food and Life Science applications.

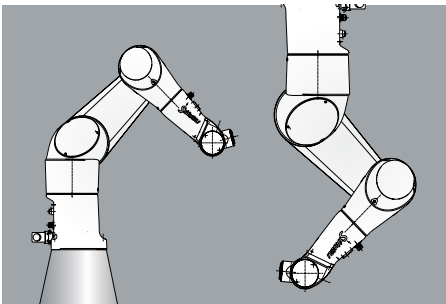

MULTIPLE ATTACHMENT METHODS

Adaptability and flexibility (floor, ceiling).

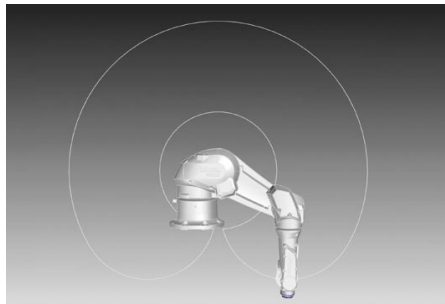

SMALL FOOTPRINT AND LARGE WORK ENVELOPE

The short robot base enables it to work shelf mounted.

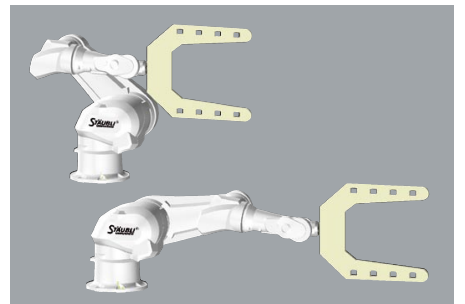

HIGH PRECISION

High path precision on straight lines for slot loading/unloading

www.staubli.com/robotics

Stäubli Faverges SCA Headquarters
FR-74210 FAVERGES (Annecy)
Tel.: +33 4 50 65 62 87
Fax: +33 4 50 65 61 30
robot.sales@staubli.com

Stäubli Tec-Systems GmbH
DE-95448 BAYREUTH
Tel.: +49 921 883 0
Fax: +49 921 883 244
robot.de@staubli.com

STÄUBLI