

B-B

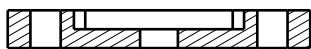

C-C

Quantidade: 4
 Material: Alumínio
 Dimensoes: 105 x 80 x 10

ATLASCAR 1

Peça que permite o acoplamento entre as dobradiças FASTEN 45x45 e a Bumblebee, a Camara termica ou a PTU

DRAWN BY Rémi Sabino	DATE 10-03-2010
CHECKED BY XXX	DATE XXX
DESIGNED BY XXX	DATE XXX

SIZE A4	DRAWING NUMBER SuporteUniversalSensores	REV X
SCALE 1:2	WEIGHT(kg) 0,12	SHEET 1/1