

CKT SIZE	PART NUMBER	DIM A	DIM B
2	78172-0002	1.2	2.6
3	78172-0003	2.4	3.8
4	78172-0004	3.6	5.0
5	78172-0005	4.8	6.2

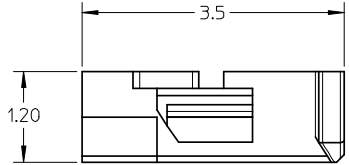
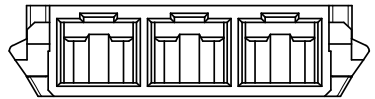
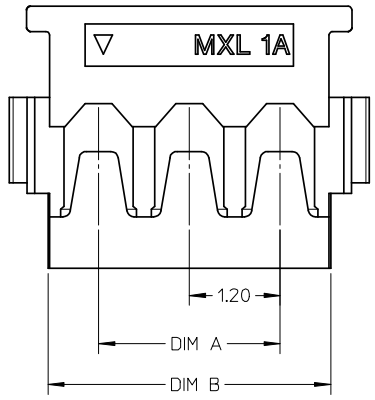

NOTES:
 1. MATERIALS:
 HOUSING: LCP, UL94V-0, COLOUR : BLACK
 2. PRODUCT SPECIFICATION: RPS-78171-006
 3. ASSEMBLE WITH CRIMP TERMINAL PART NUMBER 78172-0410 (REEL FORM)
 4. MATES WITH MOLEX PART NUMBER 78171-00**
 5. 3 CIRCUITS IS SHOWN FOR ILLUSTRATION PURPOSE ONLY

NEW RELEASE EC NO: S2008-0351 DRWN: CWLAM 2007/12/14 CHKD: KSSHANTHA 2007/12/18 APPR: NAGESHKN 2007/12/18	DESCRIPTION REV	QUALITY SYMBOLS	GENERAL TOLERANCES (UNLESS SPECIFIED) mm INCH 4 PLACES ± --- ± --- 3 PLACES ± --- ± --- 2 PLACES ± 0.2 ± --- 1 PLACE ± 0.3 ± --- ANGULAR ± 3 °	DIMENSION STYLE	SCALE	DESIGN UNITS	THIRD ANGLE PROJECTION	
				MM ONLY	NTS	METRIC		
				DRAWN BY	DATE	TITLE		
				CHECKED BY	DATE	1.20MM PITCH, W-T-B 1.40MM HEIGHT RECEPTACLE CONNECTOR		
				APPROVED BY	DATE	MOLEX INCORPORATED		
				NAGESHKN	2007/12/14	DOCUMENT NO. SD-78172-007		
				MATERIAL NO.		SHEET NO. 1 OF 1		
				DRAFT WHERE APPLICABLE MUST REMAIN WITHIN DIMENSIONS				
				SIZE	THIS DRAWING CONTAINS INFORMATION THAT IS PROPRIETARY TO MOLEX INCORPORATED AND SHOULD NOT BE USED WITHOUT WRITTEN PERMISSION			
				A3				